

OPT-J0396/OPT-J0402/OPT-J0403

Mist Catch Unit

ミストキャッチユニット

Operation Manual

取扱説明書

ENGLISH

Thank you for purchasing MIMAKI “Mist catch unit”
This Operation Manual describes the handling of the “Mist catch unit”
Read this manual carefully and make the most effective use of your printer.

Caution	2
Safety Precautions	2
How to use	4
Maintenance	5

日本語

この度は「ミストキャッチユニット」をお買いあげいただき、誠にありがとうございます。
本取扱説明書は、「ミストキャッチユニット」の取り扱いについて説明しています。
本書をよくお読みになり、お客様のニーズに合わせたプリントにお役立てください。

ご注意	7
安全にお使いいただくために	7
使用方法	9
お手入れ	10

MIMAKI ENGINEERING CO., LTD.

株式会社 ミマキエンジニアリング

D202987-10

Caution

Disclaimer of warranty

This limited warranty of Mimaki shall be the sole and exclusive warranty and is in lieu of all other warranties, express or implied, including, but not limited to, any implied warranty of merchantability or fitness, and Mimaki neither assumes nor authorizes dealer to assume for it any other obligation or liability or make any other warranty in connection with any product without Mimaki's prior written consent.

In no event shall Mimaki be liable for special, incidental or consequential damages or for loss of profits of dealer or customers of any product.

On This Operation manual









- This operation manual is describing the operation and maintenance of "Mist catch unit" (called as this unit)
 - Read this operation manual carefully and understand them thoroughly to use.
 - It is also necessary to keep this operation manual on hand.
 - This operation manual has been carefully prepared for your easy understanding, however, please do not hesitate to contact a distributor in your district or our office if you have any inquiry.
 - Descriptions contained in this operation manual are subject to change without any notice for improvement.
 - In the case when this operation manual should be illegible due to destruction or lost by fire or breakage, purchase another copy of the operation manual from our office.
 - You can also download the latest manual from our website.
 - Reproduction of this manual is strictly prohibited.
- All Rights Reserved. Copyright
© 2015 MIMAKI ENGINEERING Co., Ltd.

Safety Precautions

Symbols

Symbols are used in this operation manual for safe operation and for prevention of damage to the machine. The indicated sign is different depending on the content of caution. Symbols and their meanings are given below. Please follow these instructions as you read this manual.

Examples of symbols

Meaning	
	Failure to observe the instructions given with this symbol can result in death or serious injuries to personnel. Be sure to read it carefully and use it properly.
	Failure to observe the instructions given with this symbol can result in injuries to personnel or damage to property.
	Important notes in use of this machine are given with this symbol. Understand the notes thoroughly to operate the machine properly.
	Useful information is given with this symbol. Refer to the information to operate the machine properly.
	Indicates the reference page for related contents.
	The symbol "△" indicates that the instructions must be observed as strictly as the CAUTION instructions (including DANGER and WARNING instructions). A sign representing a precaution (the sign shown left warns of hazardous voltage) is shown in the triangle.
	The symbol "⊘" indicates that the action shown is prohibited. A sign representing a prohibited action (the sign shown left prohibits disassembly) is shown in or around the circle.
	The symbol "●" indicates that the action shown must be taken without fail or the instructions must be observed without fail. A sign representing a particular instruction (the sign shown left instructs to unplug the cable from the wall outlet) is shown in the circle.

Precautions in Use

Mist catch unit

The following printers are possible to have the Mist catch unit attached.

Model	No.	Quantity
TS300P/Tx300P	OPT-J0396	6
JV300-160/CJV300-160	OPT-J0402	5
JV300-130/CJV300-130	OPT-J0403	4

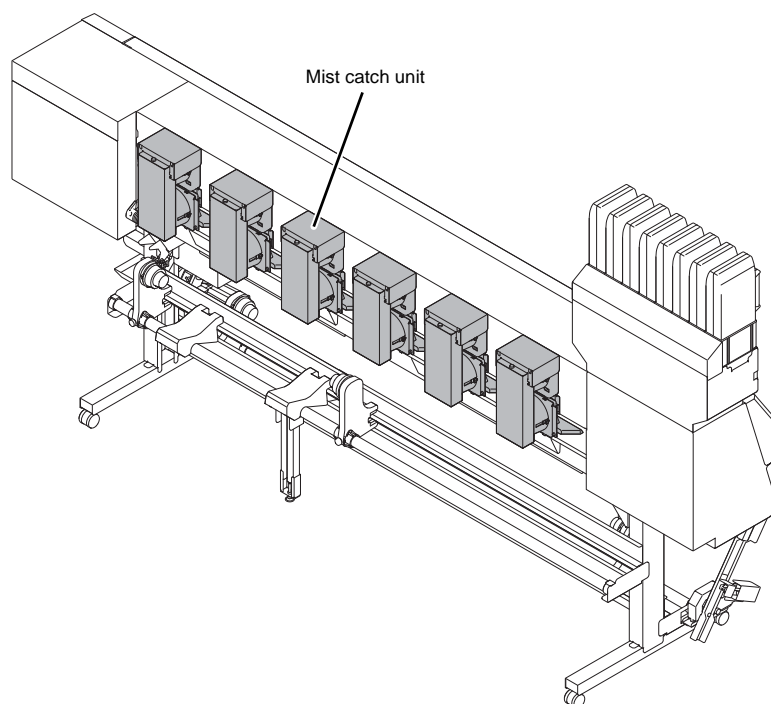

How to use

To use Mist catch unit

When using the Mist catch unit, set the ceiling FAN at "STRONG".

- 1 Select [MENU] - [MACHINE SETUP] - [TOP BLOWER].

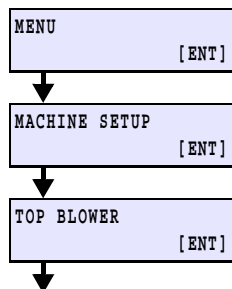

- 2 Set the power of the top blower for the strength at "STRONG".

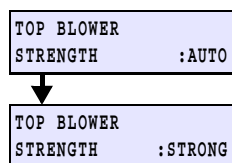

Important! • If the head gap is large, the print quality may be affected.

When not using the Mist catch unit

When not using the Mist catch unit, remove the circulation BOX assy. and the upper hose adapter and then attach the fan filter cover.

- 1 Remove the circulation BOX assy. (Plastic point M4*8 x1)

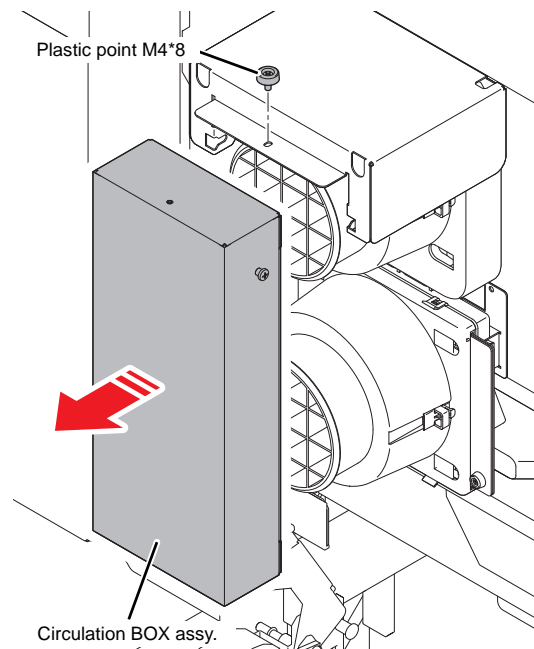

Important! • Please be careful about the loss of the plastic point.

- 2 Remove the upper hose adapter. (Hook x2)

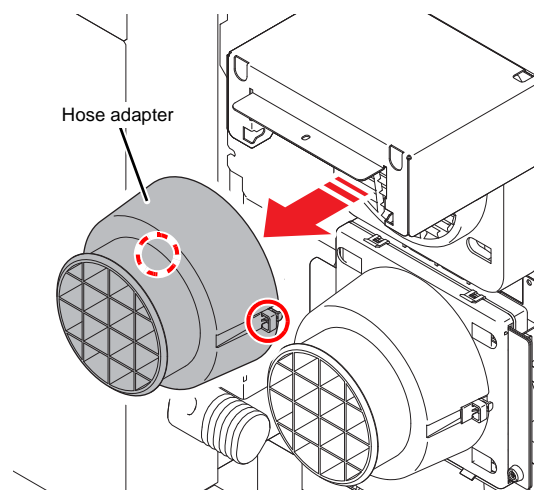

3 Attach the fan filter cover. (Hook x2)

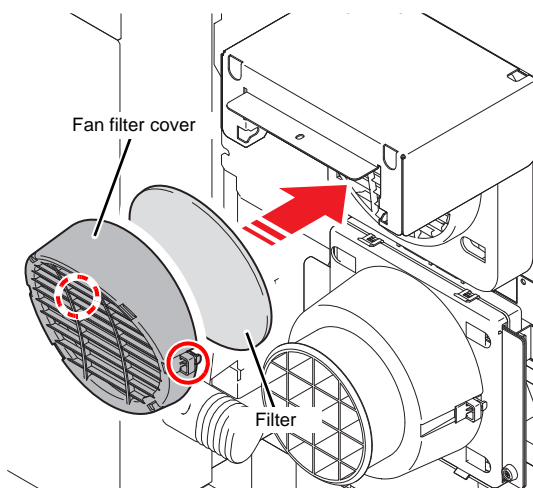

Important! • Please be careful about the loss of the filter.

4 Work for each remaining filter assy. similarly.

5 Select [MENU] - [MACHINE SETUP] - [TOP BLOWER].

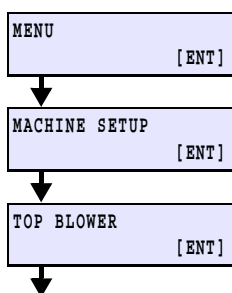

6 Set the power of the top blower for the strength at "AUTO".

TOP BLOWER
STRENGTH :AUTO

Maintenance

Maintain the machine regularly or as necessary so that its accuracy will be maintained and it can continue to be used for a long time.



- On the occasion of maintenance, please wear goggles and gloves by all means. Depending on a working condition, there is a risk that waste fluid gets into eyes and hand skin may get rough by contacting ink.
- When waste fluid gets into skin or eyes, please wash it away promptly by water.



- Take care not to pollute the surroundings with waste ink or washing liquid.

Indication of the filter maintenance

Period of use	How to care	Items to prepare
One month	Check it once a month. If it is dirty, wash (in water).	—
Six months	Replace it every six months.	Filter for exchange (supplied item 30 pcs) A105491/SPC-0810: Mist catch filter

Filter exchange procedure

1 Remove the filter assy.

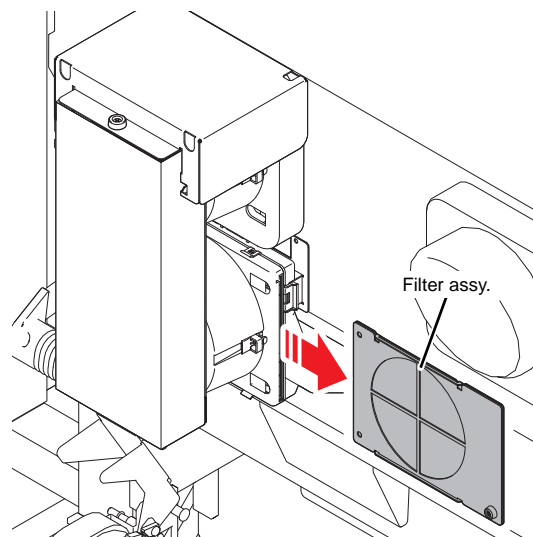

2 Remove the filter holder A and the filter. (Plastic point M3*8 x1))

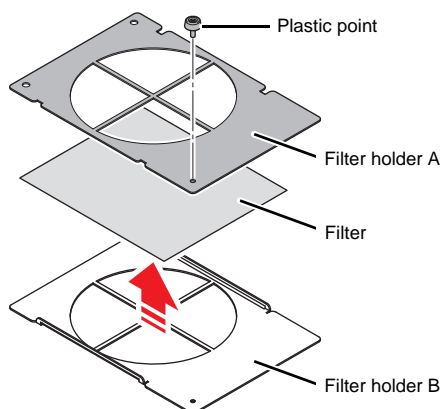

Important!

- Please be careful about the loss of the plastic point.

3 Place a new filter and attach the filter holder A. (Plastic point M3*8 x1)

- Insert a salient of the filter holder A in the upper ditch of the filter holder B.
- Insert a salient of the filter holder A in the lower ditch of the filter holder B.

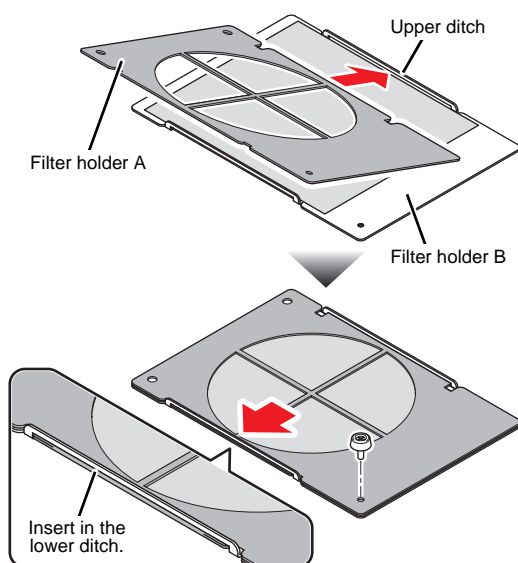

Important!

- In the case of installation, confirm that the filter covers up all the holes of the filter holder.

